

# DESIGN SPECIFICATION

: 24' 04

HUROM LS CO.,Ltd.

Material(FileName/Version)

E50SW Instruction Manual [Europe]\_V.01

2025.02.26

1. Material Specifications		2. Language	
SIZE	150 x 220 mm	English	
Printing	1color		
Paper	100g Offset paper	3. Date of Printing and Revision	
		1. 2025.02.26_V.00	
Page	76p		
Post-processing	胶装 Perfect Binding		

## 4. Details of modification

When printing for order, delete this page (specification) and proceed

# **SANA 818**

## INSTRUCTION MANUAL

03 English

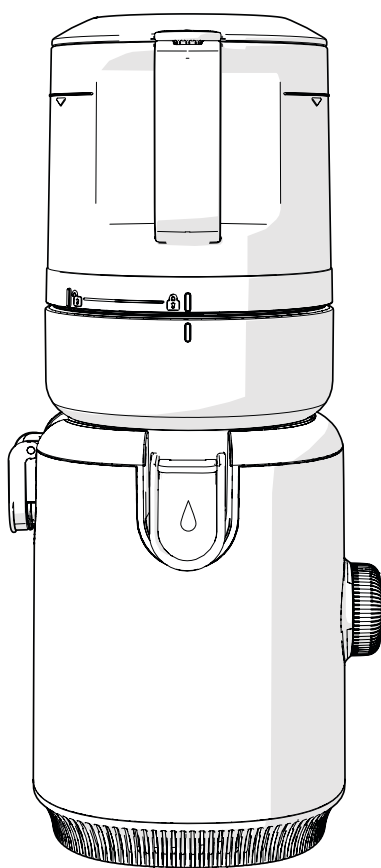

### **P.03-P.17 English**

#### **Instruction Manual | 818 Series**

[ Home use only / Warranty not included ]

### **P.18-P.31 Deutsch**

#### **Bedienungsanleitung | Serie 818**

[ nur zum Haushaltsgebrauch / Garantie nicht enthalten ]

### **P.32-P.47 Français**

#### **Mode d'emploi | Série 818**

[ Utilisation domestique uniquement / Garantie non incluse ]

### **P.48-P.61 Italiano**

#### **Manuale di istruzioni | Serie 818**

[ Solo per uso domestico / Garanzia non inclusa ]

### **P.62-P.75 Česky**

#### **Návod k použití | Řada 818**

[ Pouze pro domácí použití / záruka není zahrnuta ]

# IMPORTANT SAFEGUARDS

WHEN USING ELECTRICAL APPLIANCES, BASIC SAFETY PRECAUTIONS SHOULD ALWAYS BE FOLLOWED INCLUDING THE FOLLOWING:

English

1. WHEN USING ELECTRICAL APPLIANCES, BASIC SAFETY PRECAUTIONS SHOULD ALWAYS BE FOLLOWED. READ ALL INSTRUCTIONS.
2. TO PROTECT AGAINST RISK OF ELECTRICAL SHOCK, DO NOT PUT THE MAIN BODY (MOTOR) IN WATER OR ANY OTHER LIQUID.
3. THIS APPLIANCE IS NOT INTENDED FOR USE BY PERSONS (INCLUDING CHILDREN) WITH REDUCED PHYSICAL, SENSORY, OR MENTAL CAPABILITIES, OR LACK OF EXPERIENCE AND KNOWLEDGE, UNLESS THEY ARE CLOSELY SUPERVISED AND INSTRUCTED CONCERNING USE OF THE APPLIANCE BY A PERSON RESPONSIBLE FOR THEIR SAFETY. CLOSE SUPERVISION IS NECESSARY WHEN ANY APPLIANCE IS USED BY OR NEAR CHILDREN. CHILDREN SHOULD BE SUPERVISED TO ENSURE THAT THEY DO NOT PLAY WITH THE APPLIANCE.
4. TURN THE APPLIANCE OFF, THEN UNPLUG FROM THE OUTLET WHEN NOT IN USE, BEFORE ASSEMBLING OR DISASSEMBLING PARTS AND BEFORE CLEANING. TO UNPLUG, GRASP THE PLUG AND PULL FROM THE OUTLET. NEVER PULL FROM THE POWER CORD.
5. AVOID CONTACTING MOVING PARTS. DO NOT ATTEMPT TO DEFEAT ANY SAFETY INTERLOCK MECHANISMS.
6. DO NOT OPERATE ANY APPLIANCE WITH A DAMAGED CORD OR PLUG, OR AFTER THE APPLIANCE MALFUNCTIONS, OR IS DROPPED OR DAMAGED IN ANY MANNER. RETURN APPLIANCE TO THE NEAREST AUTHORIZED SERVICE FACILITY FOR EXAMINATION, REPAIR OR ELECTRICAL OR MECHANICAL ADJUSTMENT.
7. THE USE OF ATTACHMENTS NOT RECOMMENDED OR SOLD BY THE MANUFACTURER MAY CAUSE FIRE, ELECTRIC SHOCK OR INJURY.
8. DO NOT LET CORD HANG OVER EDGE OF TABLE OR COUNTER.
9. ALWAYS MAKE SURE HOPPER IS SECURELY FASTENED IN PLACE BEFORE MOTOR IS TURNED ON. DO NOT UNFASTEN HOPPER WHILE JUICER IS IN OPERATION.
10. BE SURE TO TURN SWITCH TO OFF POSITION AFTER EACH USE OF YOUR JUICER. MAKE SURE THE MOTOR STOPS COMPLETELY BEFORE DISASSEMBLING.
11. DO NOT PUT YOUR FINGERS OR OTHER OBJECTS INTO THE JUICER WHILE IT IS IN OPERATION. IF FOOD BECOMES LODGED IN OPENING, USE FOOD PUSHER OR ANOTHER PIECE OF FRUIT OR VEGETABLE TO PUSH IT DOWN. WHEN THIS METHOD IS NOT POSSIBLE, TURN THE MOTOR OFF AND DISASSEMBLE JUICER TO REMOVE THE REMAINING FOOD.
12. DO NOT USE OUTDOORS.
13. DO NOT PLACE ON OR NEAR A HOT GAS OR ELECTRIC BURNER OR IN A HEATED OVEN.
14. DO NOT USE APPLIANCE FOR OTHER THAN INTENDED USE.

## SAVE THESE INSTRUCTIONS

## CONTENTS

- p.04 1. Precautions for Safe Use
- p.05 2. Precautions During Use
- p.06 3. Power Dial Guide /
  - 4. Precautions Before Juicing
- p.08 5. Components
- p.10 6. How to Assemble
- p.12 7. Assembly and Disassembly of Silicone Gaskets
- p.14 8. How to Use
- p.15 9. If the Juicer Stops During Use
- p.16 10. How to Disassemble and Clean
- p.17 11. Before Requesting Repair

## Before Reading Manual

1. Read 'Precautions for Safe Use' (p. 03~05) and use the appliance properly.
2. After reading the manual, keep it in a convenient location for future reference.
3. Do not use the juicer in countries with different voltages.
4. Any quality improvements are subject to change without notice.



### 1. Precautions for Safe Use

- 01 You should read <Safety Precautions>
- 02 You should follow <Safety Precautions>
- 03 Precautions are classified as follows.



**Warning** A violation of any of the warning marks may cause a serious injury or death.

- **Do not insert or pull the power cord with wet hands.**
- **Use the right voltage only as specified on the warranty card and the product specifications. Failure to follow this instruction may result in electric shock, fire, or performance impairment.** Connecting to a different voltage may shorten the motor's lifespan or cause malfunction.
- **Securely insert the power cord plug all the way into an outlet.**
- **Do not bend, tie, damage or pull the power cord by force, or place it near a high temperature or heat such as a gas stove. Also, do not place any heavy**

**object on top of the product, wedge it into a narrow space, or alter it.**

Also, do not attempt to dismantle or repair it yourself.

- **Do not insert any foreign objects such as a finger or iron pin into any crack or hole in the product body. It may cause a fire, electric shock, injury and/or malfunction.** For after-sales service and maintenance of a product, contact the retailer where you purchased the juicer.
- **If the power cord is damaged, do not repair or alter it yourself. Instead, contact your retailer or replace it with an identical power cord.**

• **Do not get wet or splash water on the product body.** Make sure that no water or foreign material goes into the product's power switch.

- **Do not operate the power dial with wet hands.**

• **For safety, ground the power outlet at all times.** Also, do not ground it to a gas pipe, plastic water pipe, or telephone line. Make sure to use a grounded outlet.

- **Do not attempt to dismantle any parts of the chamber set or insert foreign objects such as a finger or spoon into the inlet or juice outlet during operation.**
- **Do not use it within children's reach. Children should be carefully supervised so that they do not play with this device.** There is a risk of an injury or malfunction if children accidentally hit and knock it down.

• **A person who is not familiar with handling the product should not use it him/herself.** Anyone with physical or mental problems or who lacks experience and knowledge should not use it without a supervisor present.

- **Do not use the product while wearing or holding any items with magnetic force (e.g. magnetic bracelets).** Placing magnetic objects near the product may cause malfunction.

• **The instructions for appliances shall warn of potential injury from misuse.**

- **Always disconnect the appliance from the power supply if it is left unattended and before assembling, disassembling or cleaning.**

• **Switch off the appliance and disconnect from power supply before changing accessories and during assembly/disassembly.**

- **This appliance is intended to be used in household and similar applications such as staff kitchen areas in shops, offices and other working environments.**

-farm houses.

-clients in hotels, motels, and other residential-type environments.

-bed and breakfast-type environments.



**Caution** A violation of any of the caution marks

may lead to a serious injury or death.

• **Do not operate the product unless the product body set and chamber set are securely connected.**

• **If there is a gas leak, etc., do not touch the power cord but, instead, open the windows and thoroughly ventilate the area.**

• **If the auger stops rotating during operation, turn the dial to the [REV] direction for 3 to 5 seconds to activate the reverse operation. Then, turn the dial again to the [ON] direction. If the auger doesn't start to turn, it may overheat the motor and cause damage to the juicer. If the problem continues, unplug the juicer and contact the retailer where you purchased it.**

• **Do not move the product body, or disassemble or assemble the chamber set or parts during operation.** Make sure to stop the operation and pull out the power cord beforehand.

• **When using the product, be careful so that a tie, long necklace, scarf, etc. doesn't get into the inlet.**

• **Place this product on an even and stable surface for use.**

• **When inserting ingredients into the inlet, do not use a chopstick, spoon, any hard object or anything other than the pusher.**

• **Do not use the product for more than 30 minutes continuously each time.** It may overheat the motor to cause malfunction. To operate it again, completely stop the device for about 5 minutes before use.

• **Do not exert any excessive shock to or drop the product.** The product may be damaged.

• **Do not use the juicer if it is damaged. It may not be safe and can reduce performance.**

• **If the device produces any unusual sounds, excessive heat or smoke, stop using it immediately and contact the Customer Service Center.** The smell experienced when using a new product will naturally go away over time.

• **Pull the power cord plug from the outlet when it is not in use.** Also, when pulling the power cord, make sure to grab the plug to pull it.

• **Do not clean the product at a temperature of 80°C or higher.** Do not place it in a dishwasher, dryer, microwave, etc. It may cause malfunction and/or deformation of parts.

• **The product weighs approximately 5.5 kg. When moving the product, make sure to securely hold the product body with both hands.** If you move it by holding just the chamber or the sides of the product body, the body may fall to cause a bodily injury or malfunction.

• **Do not use this household-use product for commercial purposes.** Excessive extraction of a large amount of ingredients may cause damage to the parts. This juicer is intended for home use only.



## 2. Precautions During Use

● **Make sure to thoroughly understand how to prepare ingredients and prepare them properly before inserting them.**

- Poorly prepared ingredients may hinder the extraction process and/or cause damage to the product.

● **Ingredients in need of extra care**

- When using soft ingredients alone such as bananas, ripened kiwi and tomatoes, the juice may clog inside the chamber, reducing performance. Add firm ingredients such as carrots or apples to increase the juice flow.

● **Ingredients unable to be juiced**

- Do not insert ingredients that cannot be juiced such as sesame seeds, coffee beans, Chinese peppers, tree barks and pine needles. Do not insert mudfish, eels, shrimp, marsh snails, squids, etc.

- Do not insert fruits soaked in alcohol, honey or sugar (grapes, raspberries, mulberries, etc.) and enzymes (glasswort, rock pine enzymes, etc.).

- Do not insert ingredients whose attributes make them difficult to be juiced such as silverberries, aloe, cactus, quince, yams, kudzu root, sugar cane, acorn and dandelions.

- Do not insert ice made by freezing water.

● **It is recommended that you consume extracted vegetable juice immediately, if possible, and do not refrigerate it for a long period of time.**

● **Do not use this product for pulverizing grains.** It may cause damage or malfunction.

● **Do not re-extract juice from pulp that has already been juiced.**

● **Do not run the motor with the juicer empty.**

● **Do not insert ingredients into the hopper above the guided limit mark.**

● **Do not run the motor for more than 30 minutes. It can overheat the motor. Give the juicer at least a 5 minute break every 30 minutes.**

● **Do not insert a chopstick or spoon into the juice/pulp outlet during operation.**

● **When inserting ingredients, do not use anything other than the pusher.** It may damage the parts or cause a bodily injury and/or malfunction.

● **Do not operate the power switch with wet hands.**

- It may cause electric shock, short circuit and/or fire. Do not get foreign substances on or near the power switch.

● **Use it with the juice cap open.**

- The juice can flow backwards into the hopper if the juice cap is closed while juicing.

● **Do not use when there is a large amount of water or vegetable juice in the upper section of the body.**

● **If the chamber sticks to the motor base after juicing, run the motor in reverse for 3-5 seconds.**

**Note**

1. Ingredients that have withered due to prolonged storage in the refrigerator or frozen fruits may yield very little juice, or potentially none at all.
2. If the juicer is not cleaned right after use, the pulp can dry and block the screens, leading to a poor yield and difficulty disassembling the parts. Please be sure to clean the juicer immediately after use for optimal results.

**3. Power Dial**

Turn the dial to the left or right for operation.

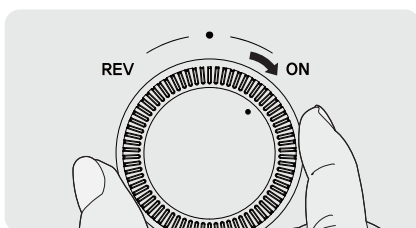

[ON]: ON - Starts the motor and makes juice.

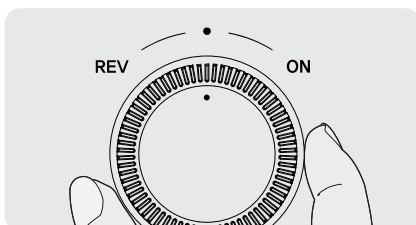

[○]: Turn the dial to the center position to stop the motor.

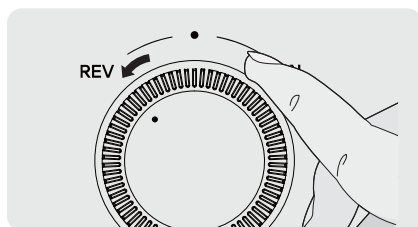

[REV]: Turn and hold the dial to the left to run the juicer in reverse. This can be helpful if the juicer jams from overfeeding. Make sure the motor completely stops before activating the reverse operation.

• If you have an allergy, make sure to select proper ingredients for your body when preparing the ingredients.

• Make sure to cut ingredients in sizes able to fit in the hopper. If you want to make a lot of juice or juice quickly, cut the ingredients into smaller pieces before inserting them. Make sure to disassemble and clean the juicer after approximately 1 kg of produce for best performance.

• Do not insert ingredients into the hopper above the guided limit mark.

• Soft ingredients like berries or soft apples can clog the juicing screen. Do not juice these by themselves, but instead with other firm produce like carrots or firm apples.

• Be sure to remove pits from pitted fruit like peaches and nectarines.

• Fibrous fruits and vegetables will make a denser juice.

• Do not juice any of the following, as this can damage the juicer.

- Ingredients that cannot be juiced such as sesame seeds, coffee beans, Chinese peppers, tree barks and pine needles
- Fruits soaked in alcohol, honey or sugar (grapes, raspberries, mulberries, etc.)
- Ingredients with minimal juice content such as silverberries, aloe, cactus, quince, bananas, yams, kudzu root, sugar cane, acorns and dandelions.
- Ice cubes

• Do not use it for grinding or milling grains.

• Refer to the instructions in **<Precautions During Operation>** (refer to p. 05).

## 4-1. How to Prepare Ingredients

- Certain ingredients need extra care during preparation. Please refer to the following instructions on how to prepare specific items of produce.
- When juicing large amounts of produce, make sure to cut ingredients into small pieces, and then repeat the "disassemble and clean after juicing" step after every kg of produce.
- For faster juicing and higher yield, cut produce into fine pieces.

### Citrus fruits

#### Grapefruit, oranges, lemons, etc.

Prepare the ingredients by peeling and cutting them into smaller pieces to fit in the hopper inlet. Remove all hard, unchewable seeds before insertion.

### Fruits with thick peel

#### Pineapples, dragon fruit, melons, watermelons, pomegranate, etc.

Prepare the ingredients by peeling and cutting them into smaller pieces to fit in the hopper inlet. Remove all hard, unchewable seeds before insertion.

### Seeded fruits

#### Grapes, apples, peaches, persimmons, plums, cherries, pears, Korean melons, etc.

For ingredients containing hard, unchewable seeds or large-sized seeds such as those in peaches, make sure to remove the pits first and cut and prepare only the flesh. Pits can cause significant damage to the juicer. Apple seeds contain toxicity so remove them as much as possible. For grapes, pluck each grape from the bunch after cleaning them thoroughly. Do not process soft ingredients like berries or soft apples by themselves. Instead, mix them with firm fruits and vegetables.

### Soft fruits

#### Single extraction (berries, cherry tomatoes, pineapples, etc.)

- Thoroughly clean and cut the ingredients into small pieces that can fit in the hopper inlet. For fruits and vegetables with stalks, remove the stalks first.

#### Mixed extraction (strawberries, kiwi, bananas, tomatoes, mangoes, etc.)

### Root vegetables

#### Carrots, beets, ginger, sweet potatoes, potatoes, garlic, etc.

Wash the ingredients in running water to remove dirt and other foreign substances. For fibrous ingredients such as ginger, peel the outer skin and cut them into small pieces. For long ingredients, cut them vertically for extraction.

### Leaf and stem vegetables

#### Celery, kale, cabbage, water parsley, wheatgrass, chives, etc.

Cut the ingredients into 3-cm or shorter pieces for juicing. Since leaf and stem vegetables are rough and fibrous, they are not easily juiced and can get caught in the auger.

## How to Use Each Strainer

### Fine Strainer

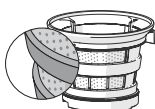

Used to extract vegetables and fruit to make juice

### Coarse Strainer (sold separately)



A coarse strainer has large openings so it is primarily used to make thick juice with solid flesh. It is ideal for when using bananas, strawberries and other ingredients whose flesh is soft as well as ingredients with thick juice. It is useful to make a smoothie, latte or soup.



**Hopper part**

Hopper

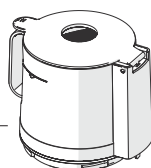

**Chamber part**

Auger



Fine Strainer



Coarse Strainer  
(sold separately)



Spinning brush



Chamber

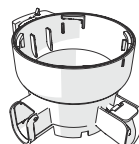

**Body part**

Power cord



Body

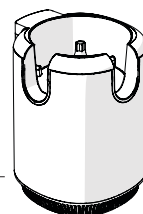

**Accessory part**

Pulp cup

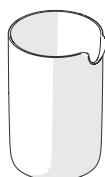

Juice cup



Cleaning brush



Pusher



Chamber details

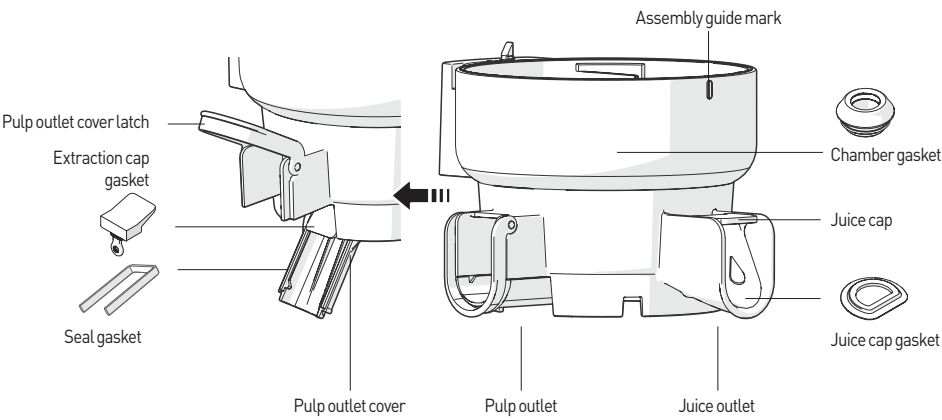

Hopper details

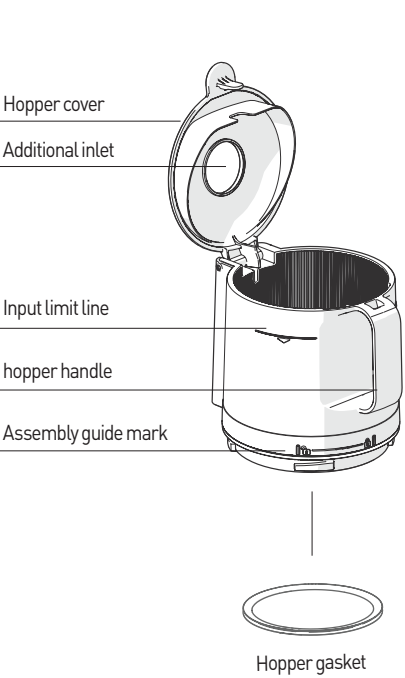

Auger / Strainer detail

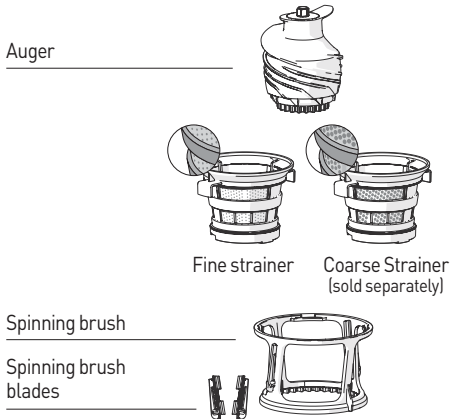

Body details

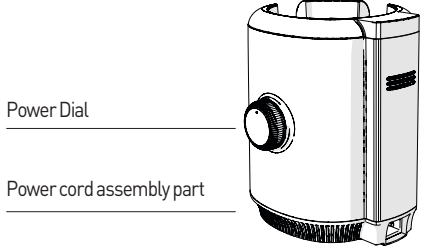

## 01 Assemble Pulp outlet cover

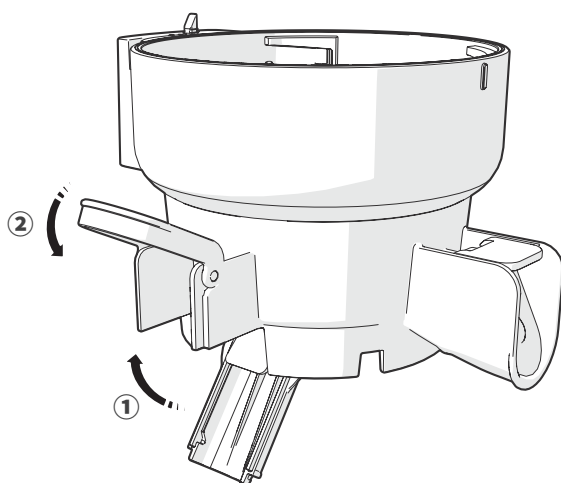

**Close the pulp outlet cover and hook the ring.**

If the gasket is incorrectly assembled or the latch is not properly closed, the pulp outlet cover may open or juice may leak while juicing.

- Make sure the extraction gasket and seal gasket are installed properly.

## 02 Assemble fine strainer + spinning brush

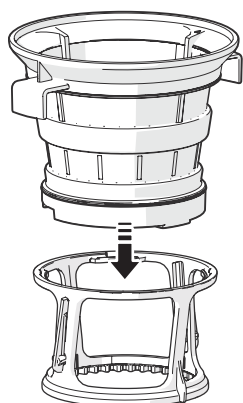

**Assemble the fine strainer and spinning brush as shown in the illustration. Push it all the way in.**

## 03 Assembling chamber

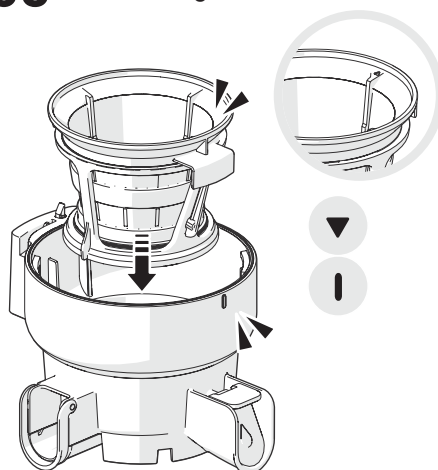

**Align the assembled fine strainer + spinning brush on the chamber groove as shown in the illustration.**

Make sure that the arrow guide mark (▼) of the fine strainer and the chamber guide mark (●) are lined up properly.

## 04 Auger installation

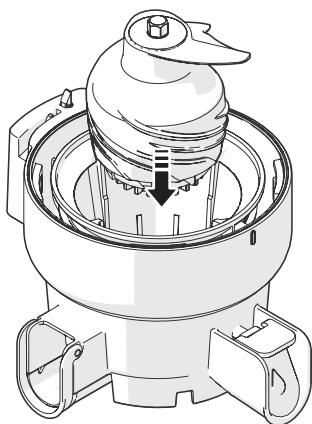

Slide the auger into the chamber. Make sure to push it in all the way.

## 05 Assembling hopper

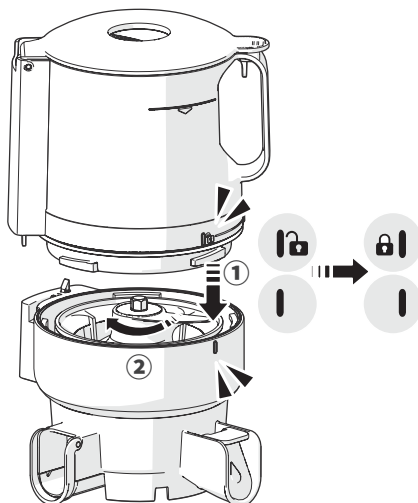

Align the marks on the chamber and hopper, then rotate it clockwise to lock it into place.

## 06 Assembling body

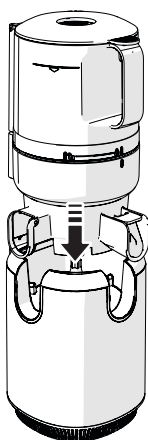

Put the assembled chamber set onto the body.

### Note

Close the hopper cover firmly, until it clicks. If the hopper cover is not properly closed, the juicer may not turn on.

**Tip:** It is easier to assemble the chamber set first, before putting it on the body.

## 12 7. Assembly and Disassembly of Silicone Gaskets

• Silicone gaskets are consumables that are recommended to be replaced annually. They are available for purchase through the your Sana retailer. The juicer may leak if the gaskets are not properly assembled.

### Extraction Gasket

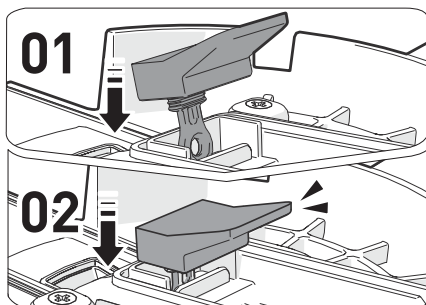

#### Disassembly

Hold and pull back on the gasket to release it. Note that it is permanently attached by a ring to prevent it from getting lost.

#### Assembly

After cleaning, insert the convex part of the gasket to hook it in place, and then press it down.

### Seal Gasket

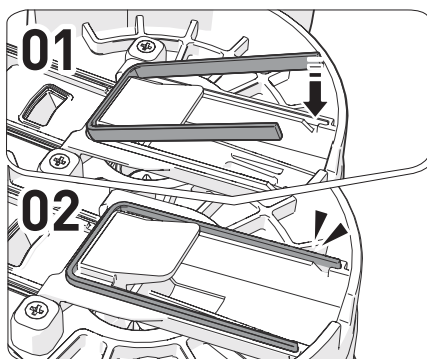

#### Disassembly

Hold and peel back the gasket to remove it.

#### Assembly

After cleaning, insert one side of the gasket into the groove. Then push the gasket in along the perimeter of the groove.

### Spinning Brush Blades

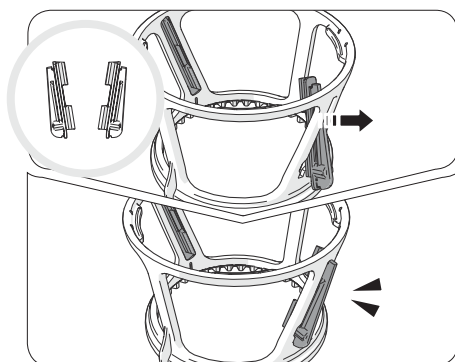

#### Disassembly

Hold the blade and pull toward the inside of the brush holder.

#### Assembly

After cleaning, attach the spinning brush blade by pulling it through the holder, from the inside to the outside, as demonstrated in the picture. Firmly grip both the top and bottom of the outer wings of the spinning brush blade, and pull them tight.

### Juice Cap Gasket

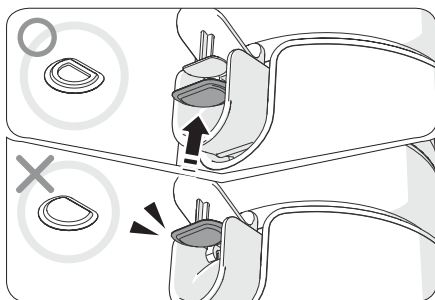

#### Disassembly

Remove the gasket by peeling it from one edge.

#### Assembly

After cleaning, insert one side of the gasket first, then press it firmly in place. Make sure the proper side is facing outward.

### Hopper Gasket

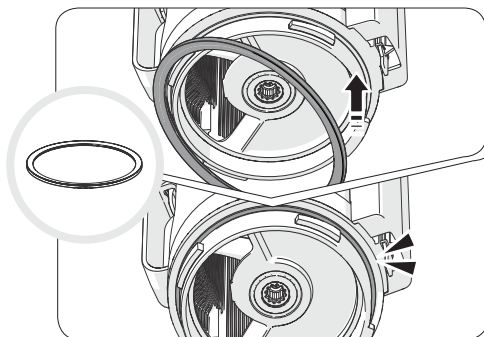

#### Disassembly

Remove the gasket by carefully peeling it out along the perimeter.

#### Assembly

After cleaning, push one side of the gasket into place. The push the gasket around the perimeter of the hopper.

### Chamber Gasket

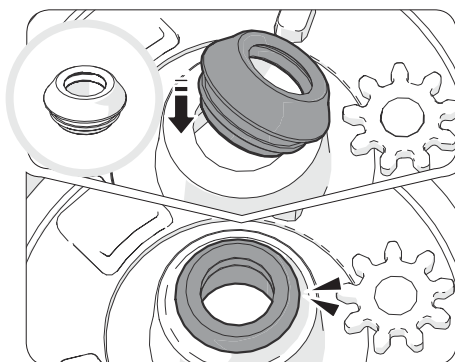

#### Disassembly

Remove the gasket by holding both sides and pulling it out.

#### Assembly

After cleaning, check the top and bottom of the gasket and insert it starting from one side. Firmly press the remaining part of the gasket, making sure it doesn't fold over.

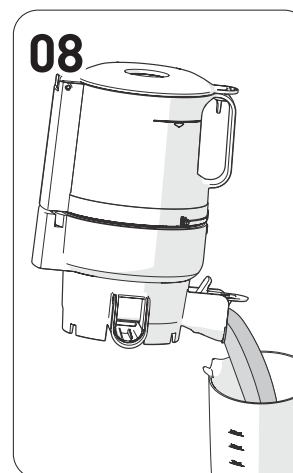
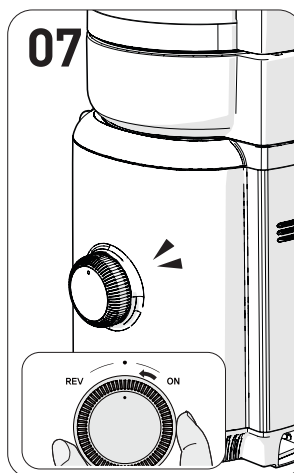
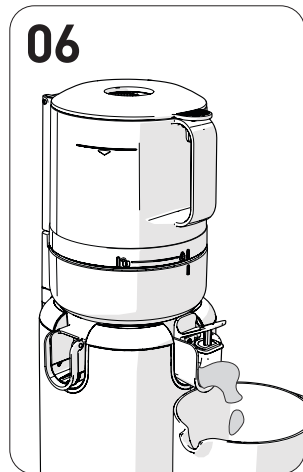
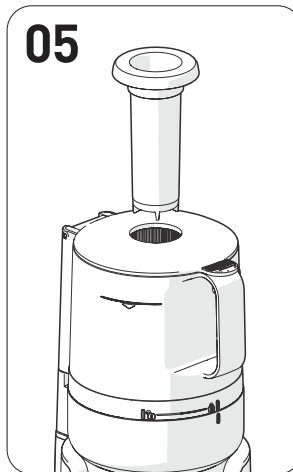
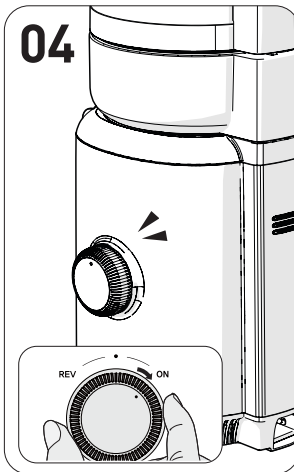
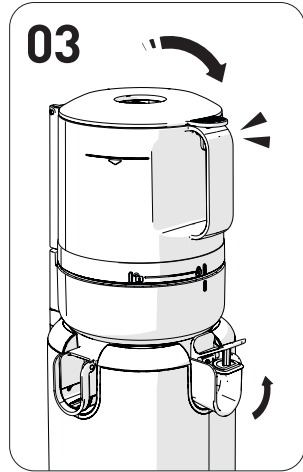
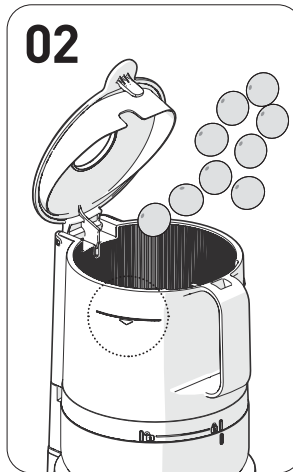
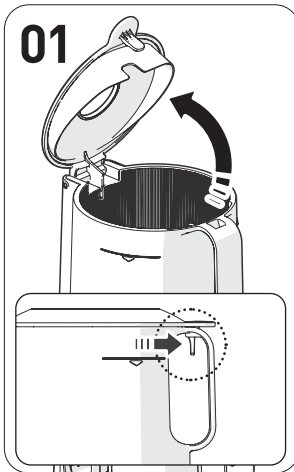

**01 Open the hopper cover.**

- ① Pull the hopper cover lever like a trigger to open it.

**02 Add produce into the hopper. Do not exceed the limit line.**

- ① For soft produce like berries or peaches, mix them with firm produce for the most effective juicing.
- ② When mixing produce, put softer and lighter produce (greens, berries, kiwi, etc.) on the bottom and firm ingredients (carrots, apples, etc.) on top.

**03 Close the hopper cover and keep the juice cap open.**

- ① Before pressing the ON button, put the juice container in place and open the juice cap.
- ② The juice may back up into the hopper if the juice cap is closed while juicing.

**04 Turn the power dial to the [ON] position to start juicing.**

- ① The initial "click" sound when turning on the juicer is the sound of the chamber set and the motor locking into place.

**05 To add more produce while juicing, use the additional inlet or open the hopper cover.**

- ① When the hopper cover is opened, the juicer automatically stops.
- ② Do not use anything other than the included pusher.
- ③ Use the pusher to press produce down if it is not feeding properly into the chamber.

**06 Let the run operate for about a minute after everything has entered the chamber.**

- ① It slowly presses and squeezes the ingredients so it takes some time until the last ingredient is juiced.
- ② Let the juicer run for a few seconds after all the juice is extracted. This will give it time to push out most of the remaining pulp, which makes cleaning even faster.
- ③ If some pulp is still in the juicer, run the motor in reverse for a few seconds, then run it normally for a few more seconds. This helps clear out any remaining pulp.

**07 Once juicing is finished, turn off the juicer by turning the power dial to the middle position.**

- ① The motor will gradually slow down and stop after about 3 seconds.

**08 Pour any remaining juice by tilting the chamber forward.**

- ① For thickly concentrated juice made of tomatoes, etc., some juice may still remain in the chamber.
- ② When removing the chamber from the body, pulp may drip from it depending on the ingredients being juiced.

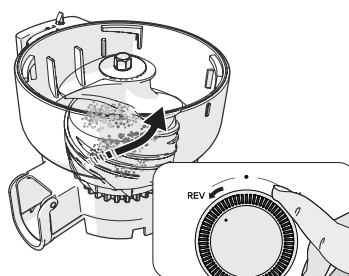
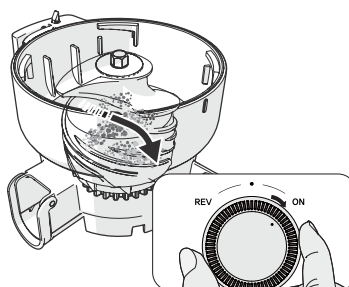
**01****02**

**01 Turn the power dial to the middle position and wait for the motor to stop. Then hold the dial in the [REV] position for 3-5 seconds. This causes the auger to turn upwards, clearing any jammed ingredients. Repeat 2-3 times if necessary. Note that the reverse function only works while the dial is being held in the [REV] position.**

**02 After the auger completely stops, turn the power dial to the [ON] direction (clockwise) to start juicing again.**

**Note**

If the juicer does not work even after following the above steps, unplug the juicer, remove the chamber set, wash it thoroughly, and try it again.



## 16 10. How to Disassemble and Clean

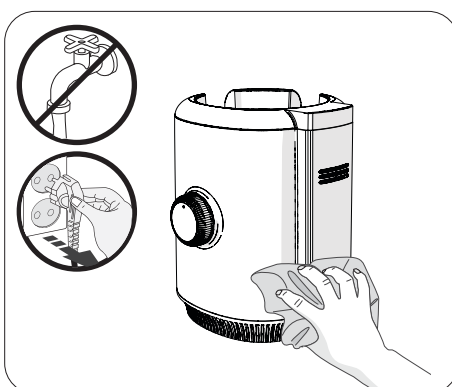

**01** Remove the chamber set from the body. Turn the hopper to remove it and then remove each part from the chamber set in order.

**02** Wash all parts with the cleaning brush under running water.

**03** Open the pulp outlet cover and juice cap to clean the chamber.

**04** Wipe the product body with a damp towel or soft cloth.

**05** Detach and wash silicone gaskets after use.

**06** Parts can be sterilized by soaking them in warm water mixed with baking soda, citric acid or vinegar.

- Failure to clean the juicer immediately after use may cause its stainless steel parts to corrode and other parts to discolor due to natural minerals and pulp from produce. In addition, without immediate cleaning, pulp can dry and get stuck inside the juicer. This can make it difficult to disassemble, and can cause reduced juice yield. Be sure to clean and air dry it completely immediately after use and store it in a clean place. Do not clean with hot or boiling water. Do not clean it with an abrasive sponge, steel sponge, abrasive cleaners, or any sharp cleaning tools. Do not clean it in a dishwasher.

## 11. Before Requesting Repair

Check the following before asking for repair. For follow-up service and any inquiry you may have while using the product, please contact your authorized Sana retailer. Make sure to reference the model number (Sana 818).

17

English

01. When the juicer starts, a "click" sound is heard.	It is the sound of the chamber and auger locking into place. This is normal.
02. The motor doesn't turn on when the chamber is not attached.	This is normal. For safety reasons, the juicer will only operate when it is properly assembled.
03. The hopper doesn't attach to the chamber.	Check if the marks on the sides of a chamber and a hopper are aligned and rotated clockwise for assembly.
04. The motor doesn't turn on after a long juicing session.	The juicer has a thermal sensor to protect the motor. If the juicer runs more than 30 minutes, it may need to cool down. Stop juicing for around 10 minutes and try again.
05. The juicer stops while juicing.	Make sure the juicer is properly assembled. The motor will only operate if all parts are assembled correctly. Refer to section 6 „How to Assemble“. The juicer may jam if it is overfilled, or filled with improperly prepared firm ingredients like beets or carrots. Refer to section 9 „If the Juicer Stops While Juicing“. For safety, the juicer will automatically stop after 5 minutes of juicing. Turn the power dial to [ON] to resume operation.
06. There are lines on the auger.	These are normal flash lines made during the production process.
07. Some juice leaks out the pulp outlet when juicing starts.	Depending on the produce being juiced, it is normal for a small amount of juice to come out the pulp outlet at the start of juicing. After a few seconds, a seal is formed and all juice will go out the juice outlet.
08. Juice backs up into the hopper.	Do not juice with the juice cap closed. It will cause backup of juice into the hopper, and poor yield.
09. Juice leaks between the hopper and chamber, or between the chamber and the body.	Check to make sure the hopper gasket and chamber gasket are in place and assembled properly.
10. The hopper is stuck to the chamber and cannot be removed.	Excessive pulp can cause pressure between the chamber and hopper, making it difficult to remove the hopper. Let the juicer run for about a minute to make sure all pulp has been removed. In case some pulp is stuck, stop the motor, then hold the power dial in the [REV] position for 5-10 seconds, up to 3 times. Then operate the motor normally for another 30 seconds. This should clear out any excessive pulp remaining. Note: that if any foreign materials or hard seeds or pits get into the chamber, it can damage the juicer. In this case, do not run the motor in reverse, but disassemble and clean out the juicer.
11. The chamber rocks from side to side during juicing.	This is normal. This juicer uses an orbital motor to drive the auger. This type of motor can cause the chamber to move from side to side while juicing. This is a characteristic of orbital motors, and may be more noticeable with hard ingredients like carrots or beets.
12. The juicer makes unusual noises with certain ingredients.	Certain produce, such as firm apples or beets, can make a loud high-pitched sound while being juiced. This is a characteristic of the ingredients being squeezed against the auger and is normal.





